

# Zirkona Joiner System

Art. No. 60000 series

## Note!



Always apply thread lockers on 20 mm threads. Use Loctite or equivalent.

## Zirkona Joiner

Install the round installation plate, Quick Release or Vesa installation plate in a suitable location with 4 M6 screws. Alternatively, use Zirkona Quicker in order to affix it to a flat window or a flat metal surface. The computer holder is adapted for usage with laptops.

**Note!** Clean the mounting surface and the Quicker rubber surface with water or window cleaner. Moisten the rubber surface somewhat before installing the Quicker. Press the Quicker hard against the mounting surface and pull down the locking lever. Re-install at least once per month.

Fasten the Zirkona joiner into the round installation plate or in the Vesa installation plate.

Install the appropriate Zirkona tubes (50, 100, 150 or 300 mm) onto the Zirkona Joiner.

If the mount is to be further extended, use a 20 mm thread adapter and connect another tube.

Fasten to the suitable upper mount, round installation plate or Vesa installation plate with the help of the thread adapter.

Add screens, computer, TV or similar products to Vesa installation plate. Use round installation plate for mounting on solid and hard surface mounting area.

**Caution!** Do not exceed maximum weight. See charts below. Measure from Joiner adjustment point.

### Weight Chart (vibrations)

(When mounted where vibrations may occur, e.g. vehicles, etc.)

Tube length:	0-50 mm	100 mm	150 mm	300 mm
Joiner Small:	3 kg	3 kg	2 kg	1.5 kg
Joiner Medium:	6 kg	5.5 kg	5 kg	3.5 kg
Joiner Large:	10 kg	8 kg	6 kg	4.5 kg

### Weight Chart (still position)

(When mounted in non-moving position, e.g. TV screens, etc.)

Tube length:	0-50 mm	100 mm	150 mm
Joiner Medium:	20 kg	16kg	12 kg
Joiner Large:	30 kg	24 kg	20 kg

**Caution!** Note that neither the 300 mm Tube nor the Joiner Small should be used for mounting TV screens.

**Warning!** An incorrectly installed holder can cause severe damage both vehicle and occupants if placed so that it could potentially interfere with the operation of the vehicle, either because of its placement or from failing to stay mounted.

When attaching the holder to the vehicle, make sure the mounting area is a solid flat surface that can support the weight.

Attachment to non-metal surfaces must be done with bolts and nuts only. Use wide washers to protect the surfaces.

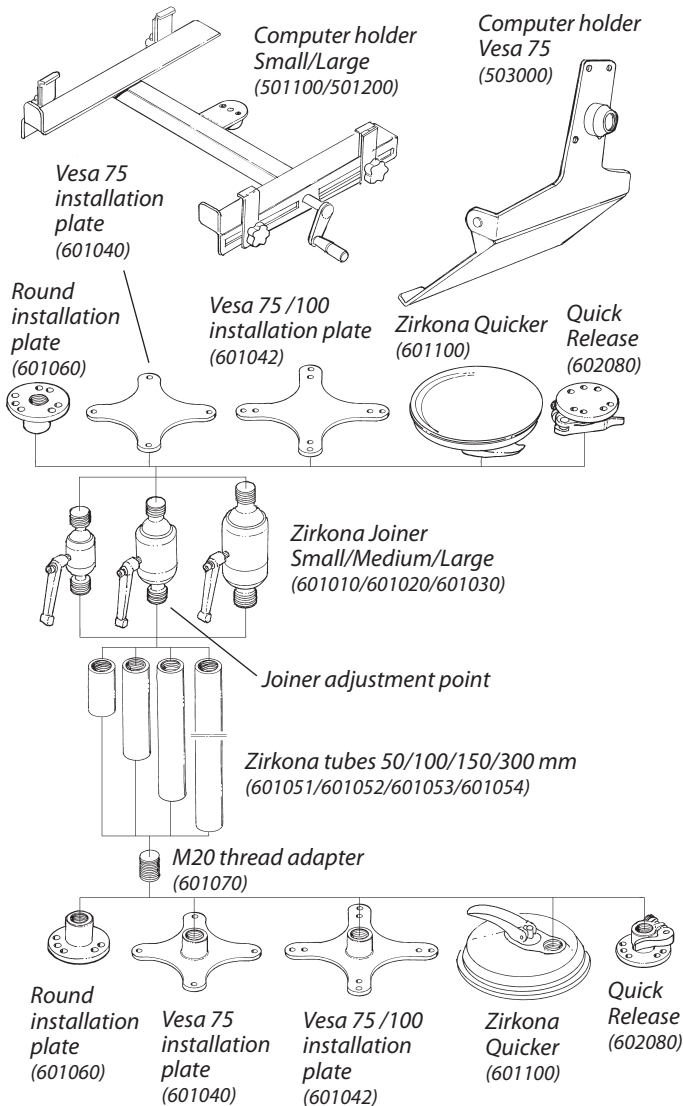

Version 1, 2010-06

**Zirkona**  
www.zirkona.com

Zirkona Sweden AB assumes no responsibility for the installation or use of the product. All responsibility rests with the user.