

General hazard information:

- The screws for mounting the TV must not be too long, otherwise the TV could be damaged inside.
- Please ensure that the cables are not damaged during installation. Damaged cables must be replaced immediately to avoid short circuits.
- Screws must always be screwed in straight way. Please do not damage the threads of the screws, otherwise the stability of the product cannot be guaranteed.
- Observe the weight limit of the respective TV mount as specified: www.wissmann-raumobjekte.de
- TV mounts are not suitable as children's toys (damage to the product and risk of injury can be the result of improper handling)
- Claims for damage or possible warranty claims due to incorrect installation or incorrect handling cannot be made to the manufacturer.
- **Products made of glass:** observe the weight limit at www.wissmann-raumobjekte.de.

Caution, glass is brittle and splinters if tilted. Always place on soft surfaces. Broken or splintered glass is a risk of accidents and should therefore be disposed of immediately.

- **TV mounts with wheels:** replace stiff wheels to avoid damage to soft wooden floors.
- **TV mounts with a rotating function:** To prevent damage to the cables due to tension, insert them loosely so that the cables are not pulled too tightly when the TV is rotated. To avoid chafing of the cables, use the spiral cover as cable protection at the cable entry.
- **TV mounts with a rotating function:** If a rotation axis is stiff (TV can hardly be rotated or cannot be rotated at all), please stop using the product and contact the manufacturer immediately: info@wissmann-raumobjekte.de
- **TV mounts for wall mounting:** our dowels are not suitable for all types of walls. Therefore, only use dowels suitable for your wall.
- **TV mounts for wall mounting:** If the wall holes were drilled too large, be sure to use larger dowels or alternatively adhesive dowels.
- **TV mounts for wall mounting:** The load-bearing capacity of the wall must be ensured by the user (the upper screws of the wall bracket bear the weight of the TV under tensile load)

Installation instruction: TV mount solution art128-0

Before starting the assembly please read these instructions with patience and follow step by step.

I.) Wall fixation (Time needed: approx. 20 min.)

The vertical column can be placed either on the right or left-hand side of the TV.

- 1) Establishing the height of the TV bracket: Hold the vertical cover on the desired position in the room vertically on the wall and mark the square cut-out on the wall.

Note: Leave at least 1.5 cm above the base for the cable.

- 2) The height marked in the cut-out is now the height of the extension arm. Arrange the wall mounting plate straight at this height, mark the holes and drill to match the wall plugs supplied.

Note: Fig. 1 and Fig. 2 shows the plate to install the TV. This plate is NOT the wall mounted plate!

Note: The wall plugs and screws supplied are not suitable for wooden or plasterboard walls. The customer must ensure the wall is strong enough and able to bear the weight of a flat screen TV.

Note: Under no circumstances drill the holes for the wall plugs too big. Otherwise the TV could hang crooked when pivoting.

- 3) Mount the mounting plate on the wall.
- 4) Loosen the two screws on the TV bracket (Fig 1, yellow arrow) and remove the black plastic part (Fig 2, red arrow).

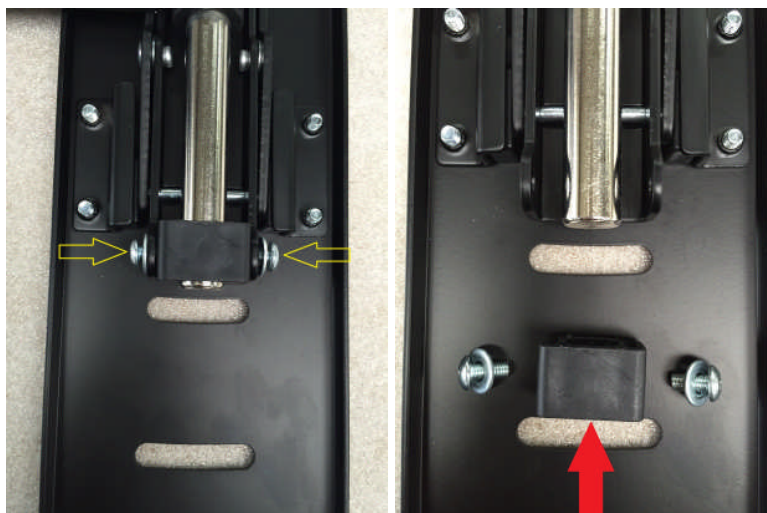

Fig. 1

Fig. 2

- 5) Pull the axle (Fig 3, green arrow) out of the socket (Fig 3, red arrow) on the end of the extension arm.

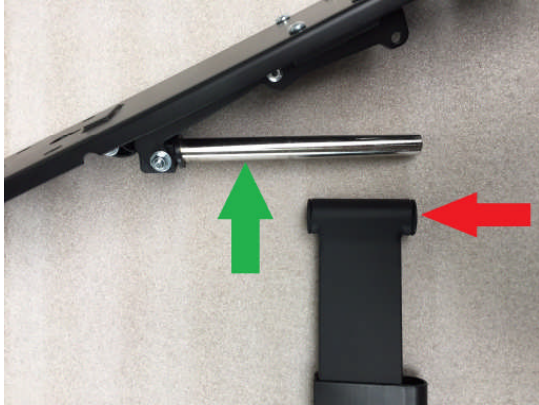

Fig. 3

- 6) Bring the cover shell over the extension arm (Fig 4) up to the wall bracket
Please note: The film on the extension arm acts a scratch protector. Please only remove the film when the cover shell is mounted on the wall bracket.

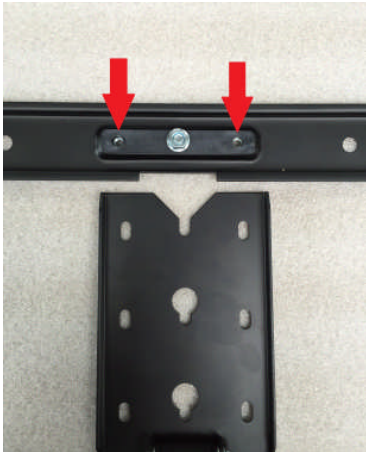

Fig. 4

- 7) Then repeat point 5) and 4): Place the axle in the socket and mount the black plastic part.

II.) Mounting of the flat screen

- 1) Assemble the flat profiles attached, length 620mm (24,4 inches) horizontal backwards on to the flat screen. There are two threads on the upper profile (Fig 5, red arrow).



Note: The screws attached may be too short and must be replaced with longer screws. When fitting the TV-Bracket, washers are to be used.

Note: When using longer screws, please slowly test that they are not too long and bump against something. – The TV could be damaged from the inside.

Note: cables could be plugged into the TV in the area of the lower, horizontal cross bar! In that case either don't install the lower cross bar to the TV or use small discs as a distance between cross bar and TV.

- 2) Guide the flat screen with the threaded pins on the back into the vertical bracket rails, make sure it looks straight, and fasten with the 2 nuts and screws from behind.
- 3) Then bring the cable under and along the pivot arm and bring the black cable holder (Fig 6, green arrow) over the arm and click into position.

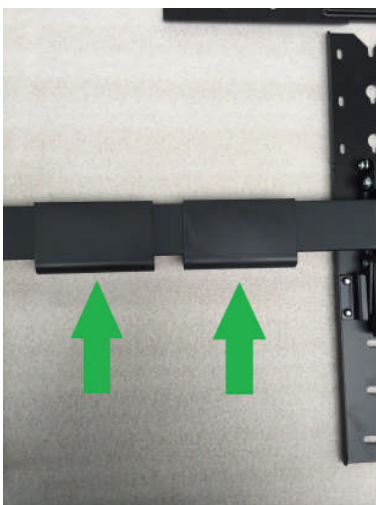

Fig. 6

- 4) Bring the cable out of the black cable holder into the vertical cover shell and then mount the cover shell to cover the cable.



Fig. 7

Note: As the bracket art128 Size 0 is designed for smaller TV's, there is space for a maximum of 2 to 4 cables (depending on the diameter of the cables).

Note: Should the flat screen be inclined to slope, please check that the dowels in the wall are fitted securely in place (possibly, the holes have been drilled too large) – plastering the dowels could improve the grip.

Final information:

- The solution art128 is produced in fine brushed stainless steel. This material is very sensitive for fingerprints. We did a special surface protection and recommend to renew that every few months to avoid those spots of fingerprints (bottle to renew the surface protection is added to the package: Chromol).